

**This electronic collection of documents is provided
for the convenience of the user
and is Not a Certified Document –**

**The documents contained herein were originally issued
and sealed by the individuals whose names and license
numbers appear on each page, on the dates appearing
with their signature on that page.**

**This file or an individual page
shall not be considered a certified document.**

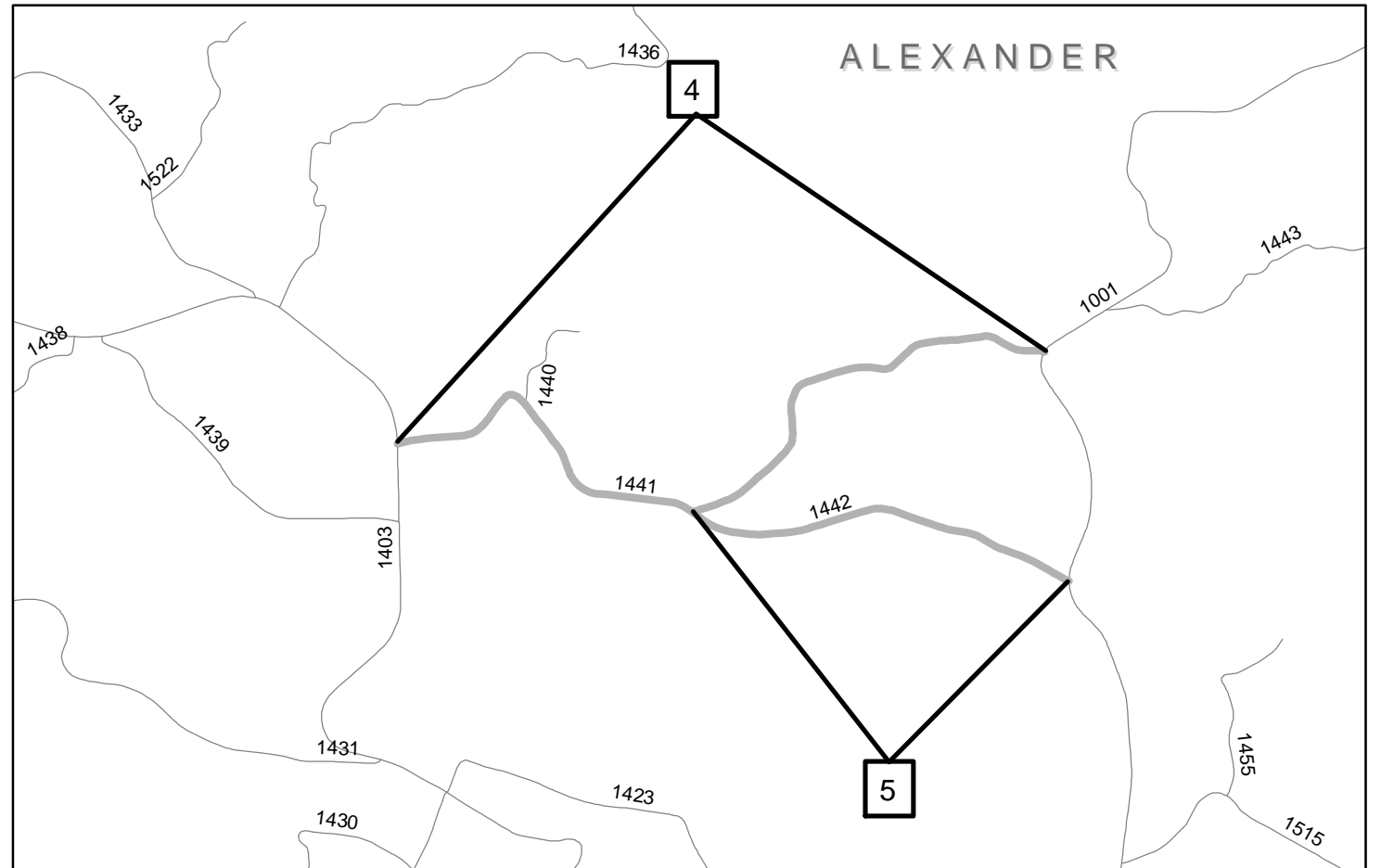

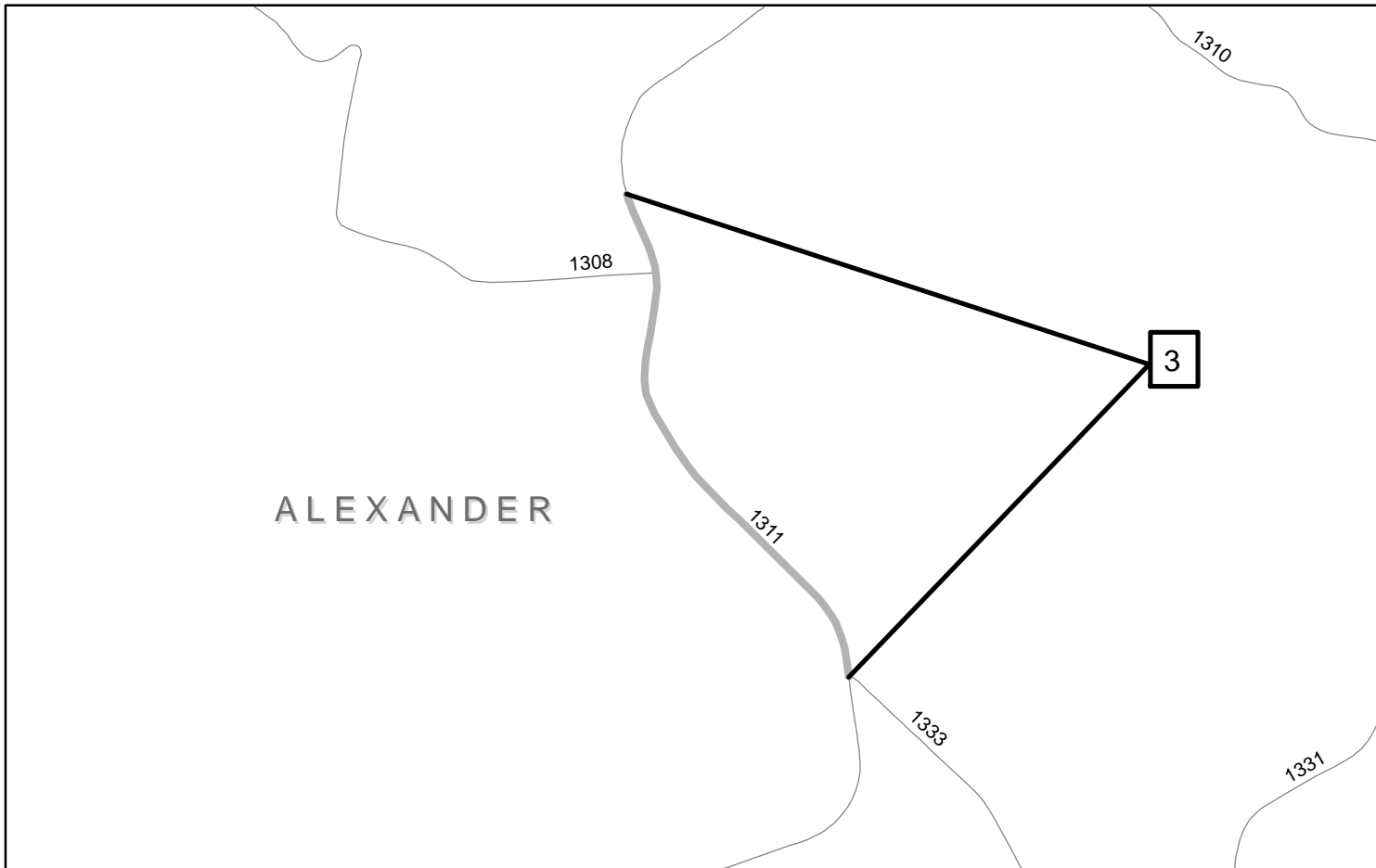
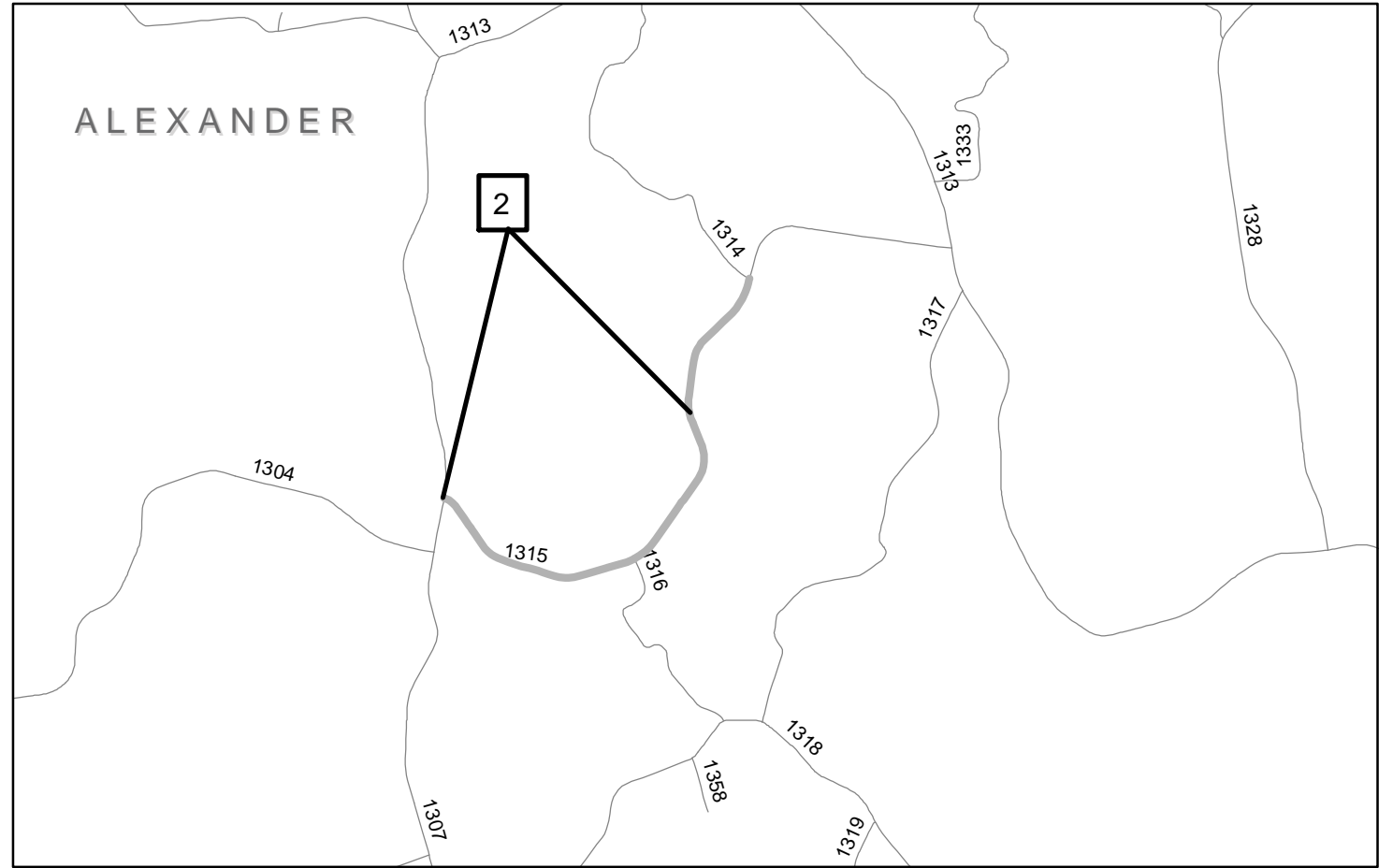
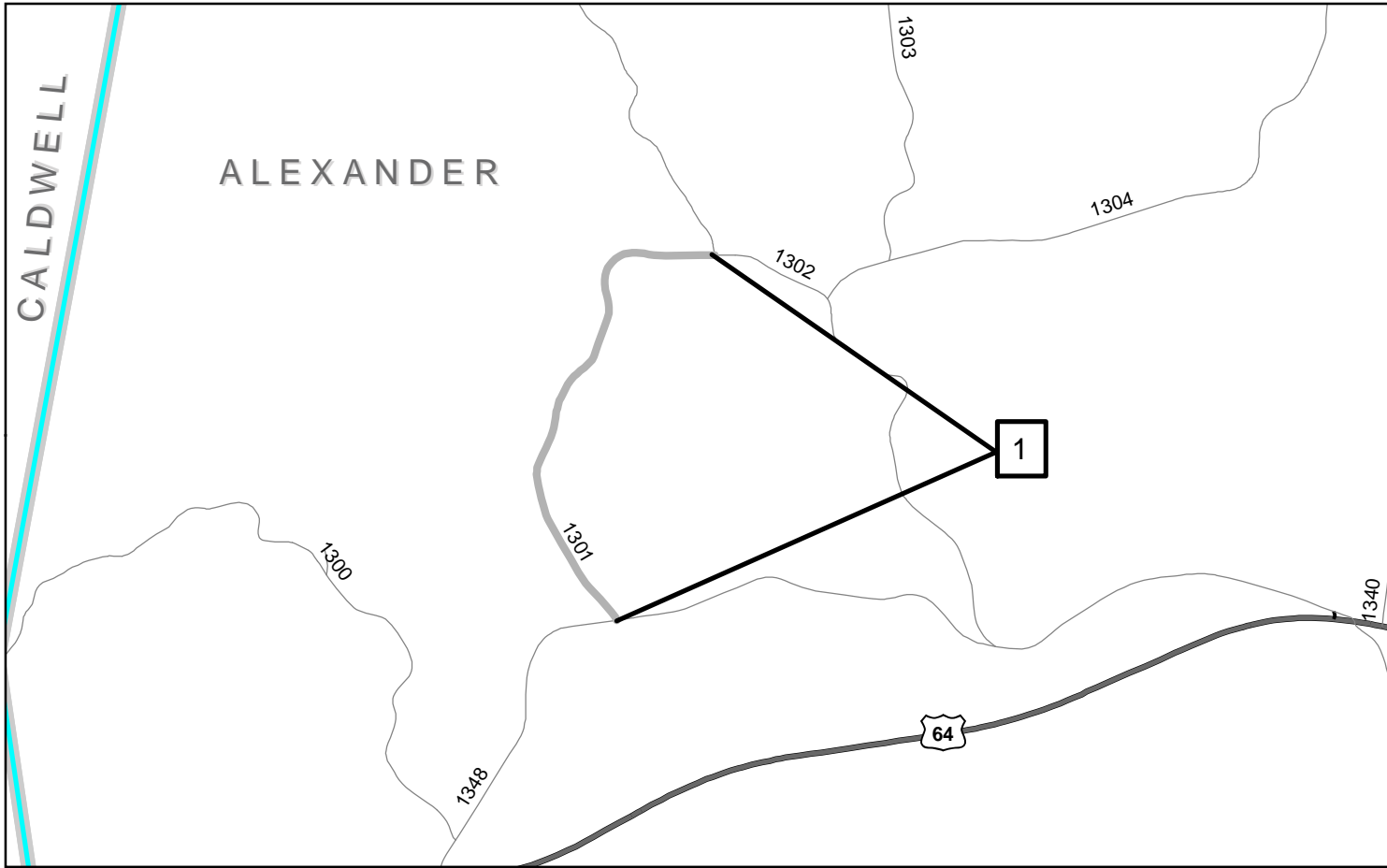
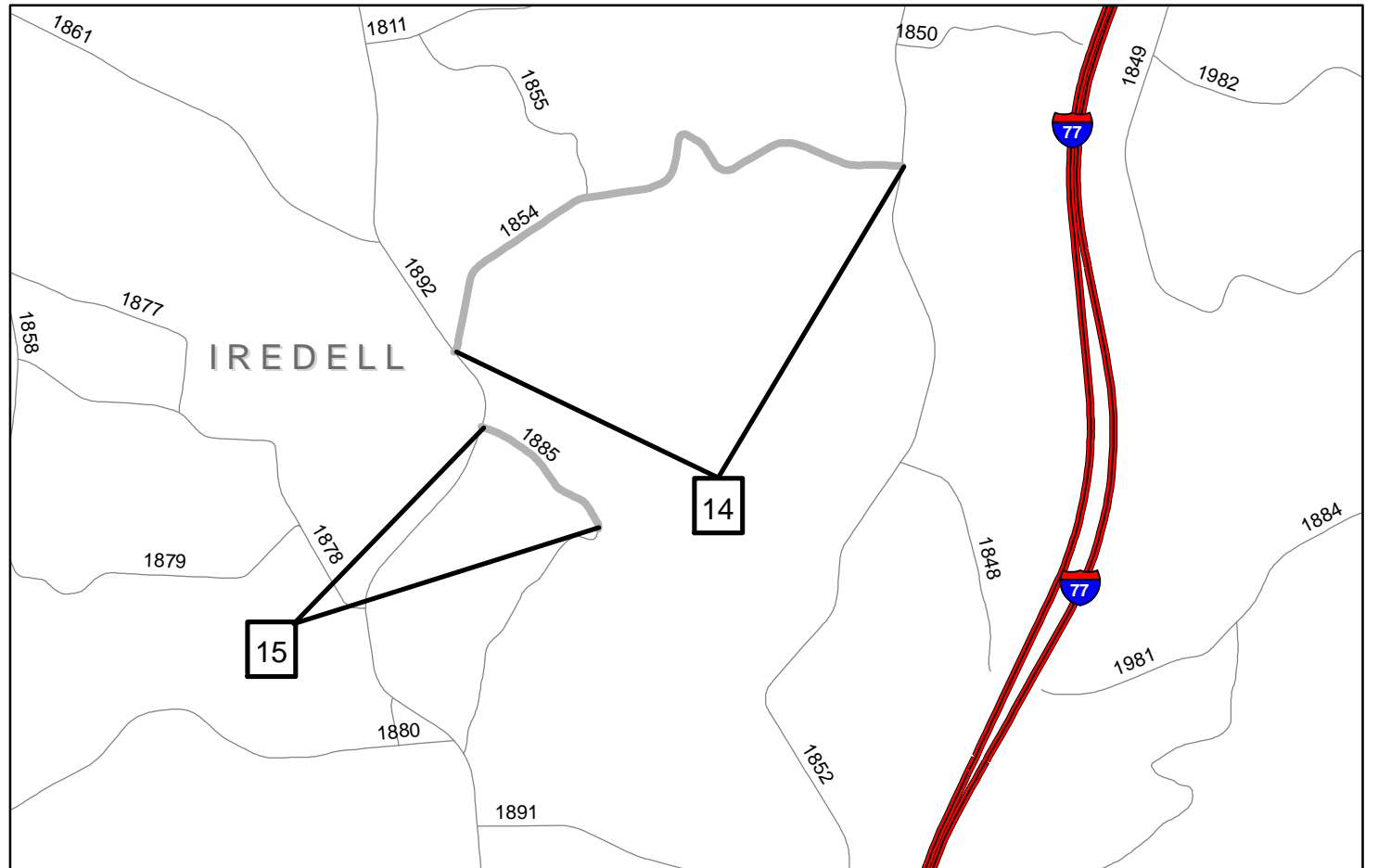
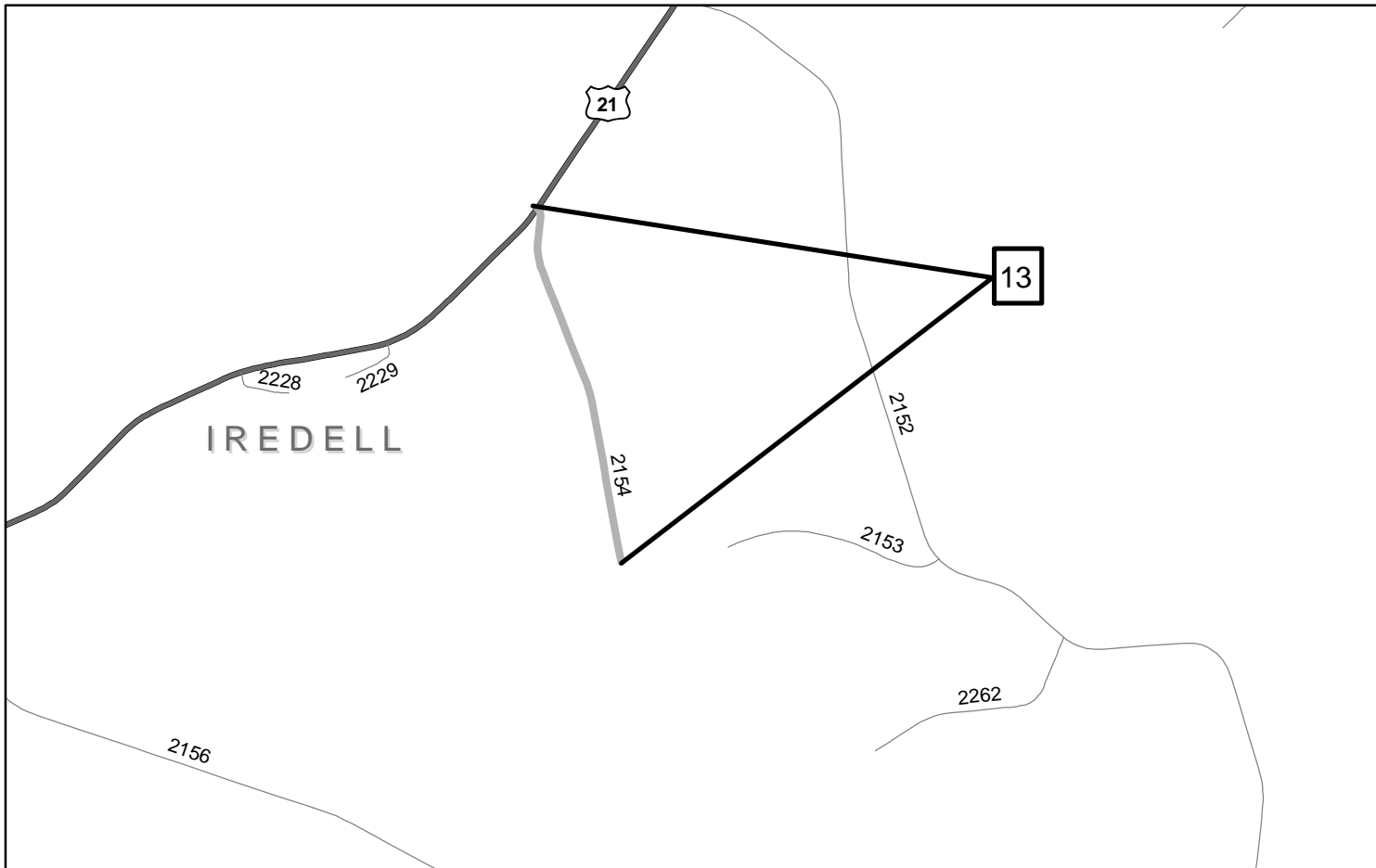
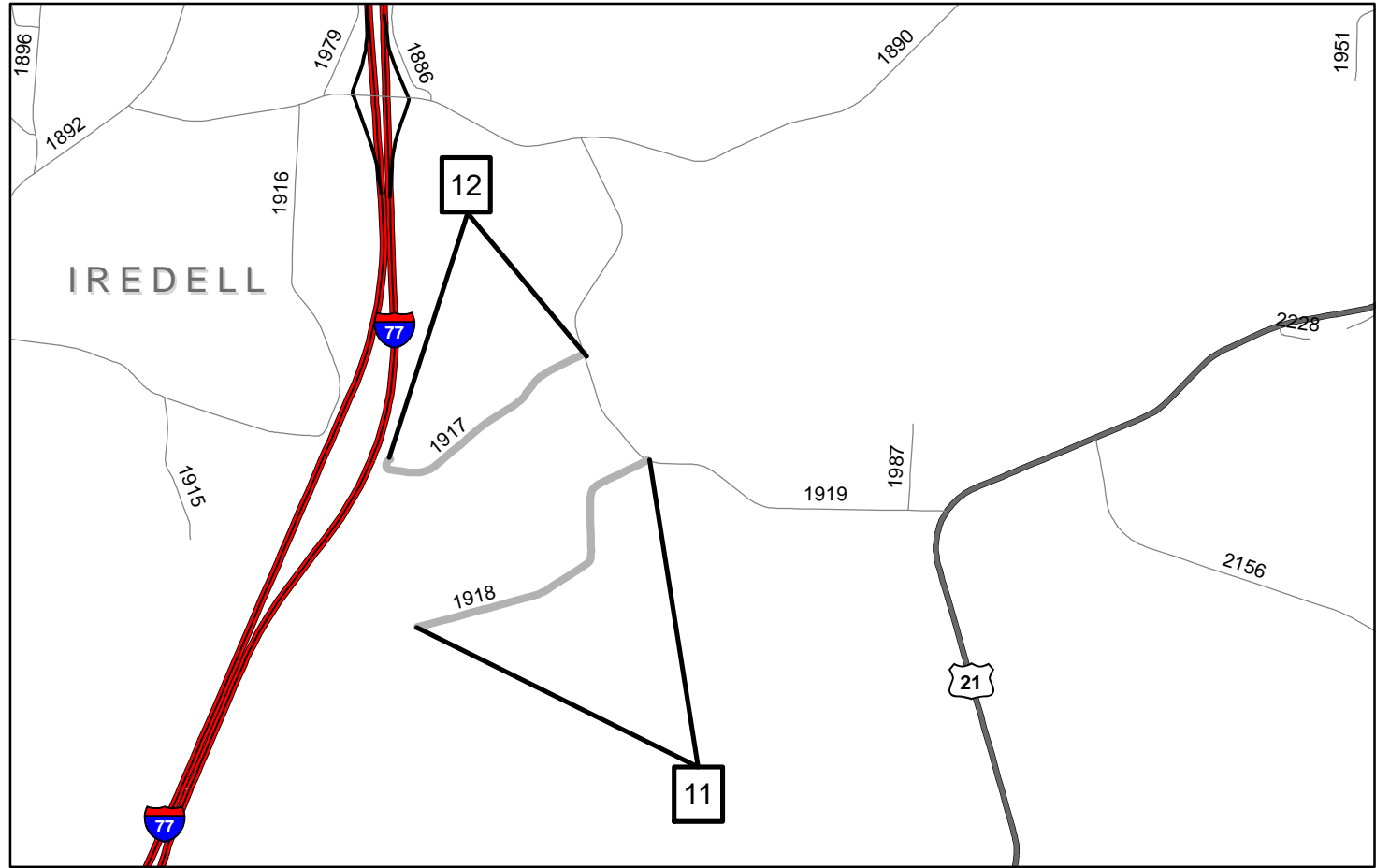
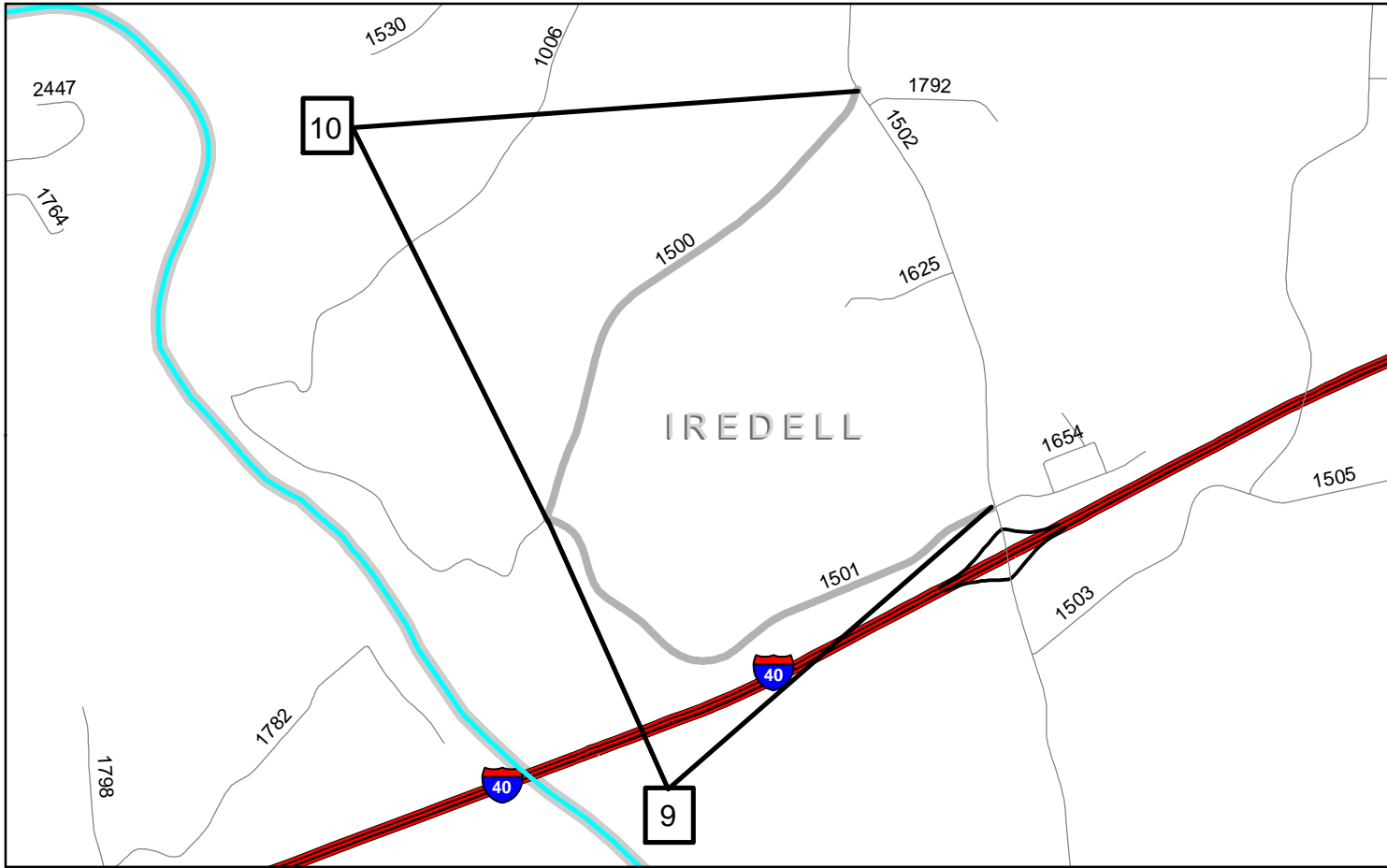

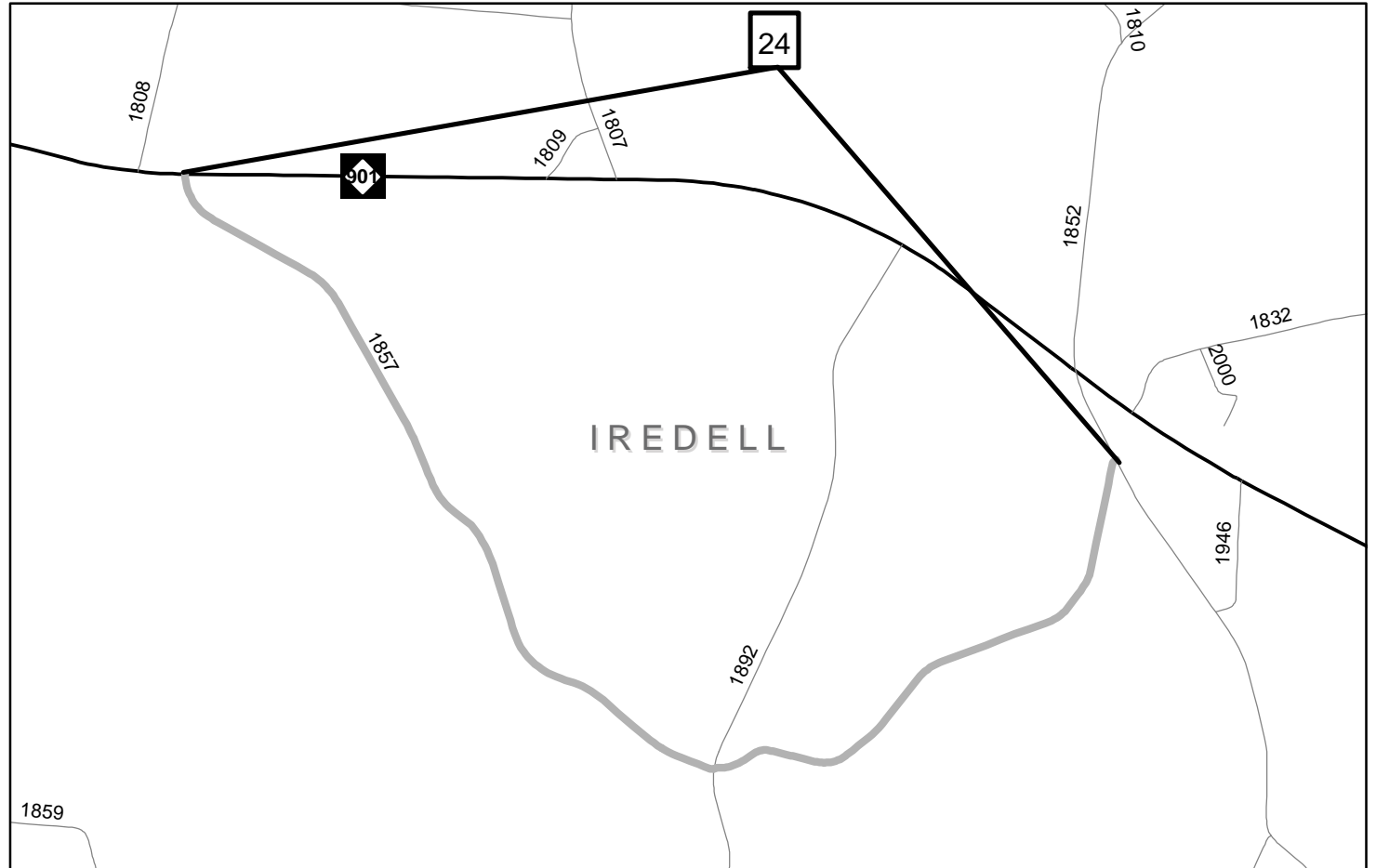
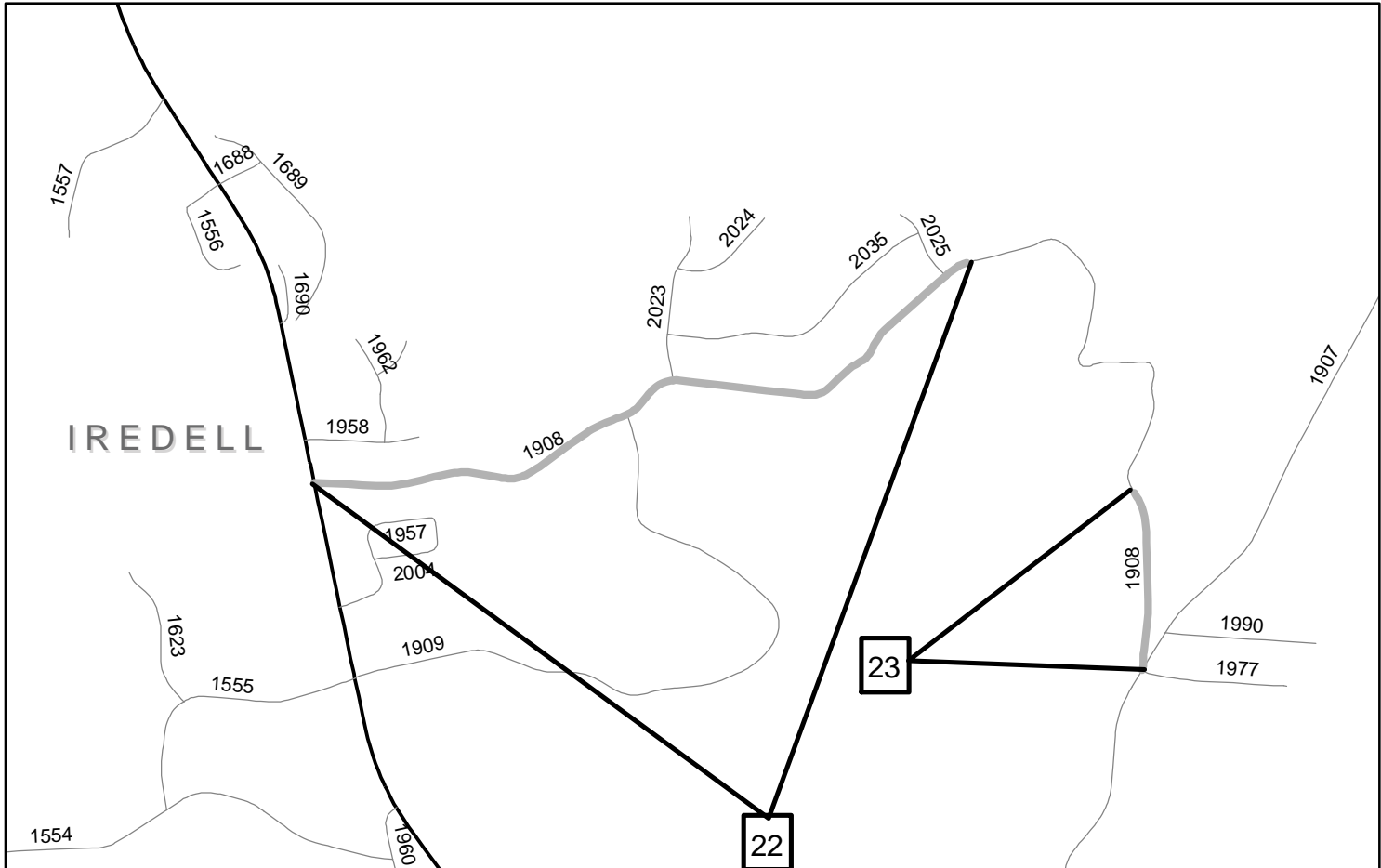
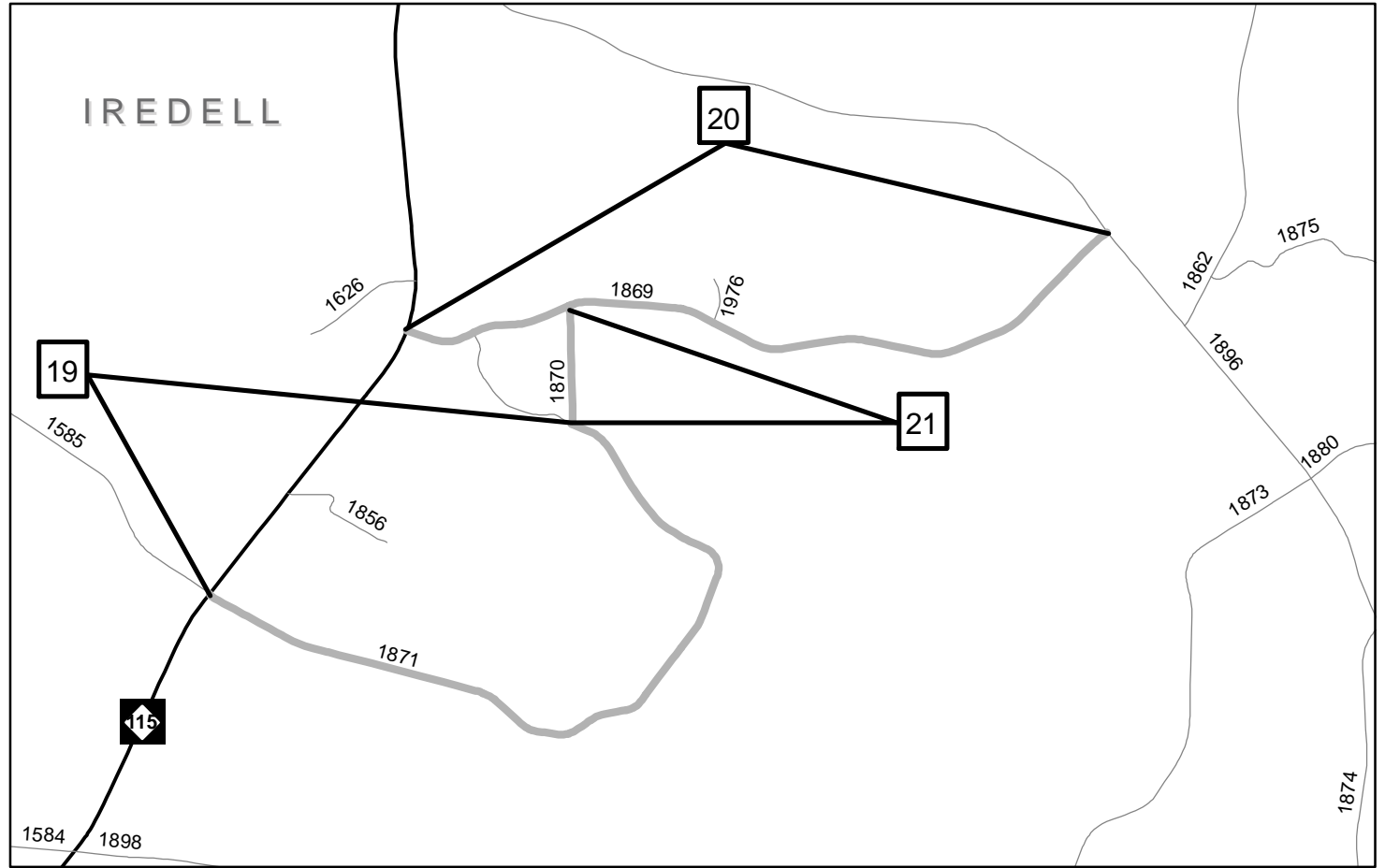
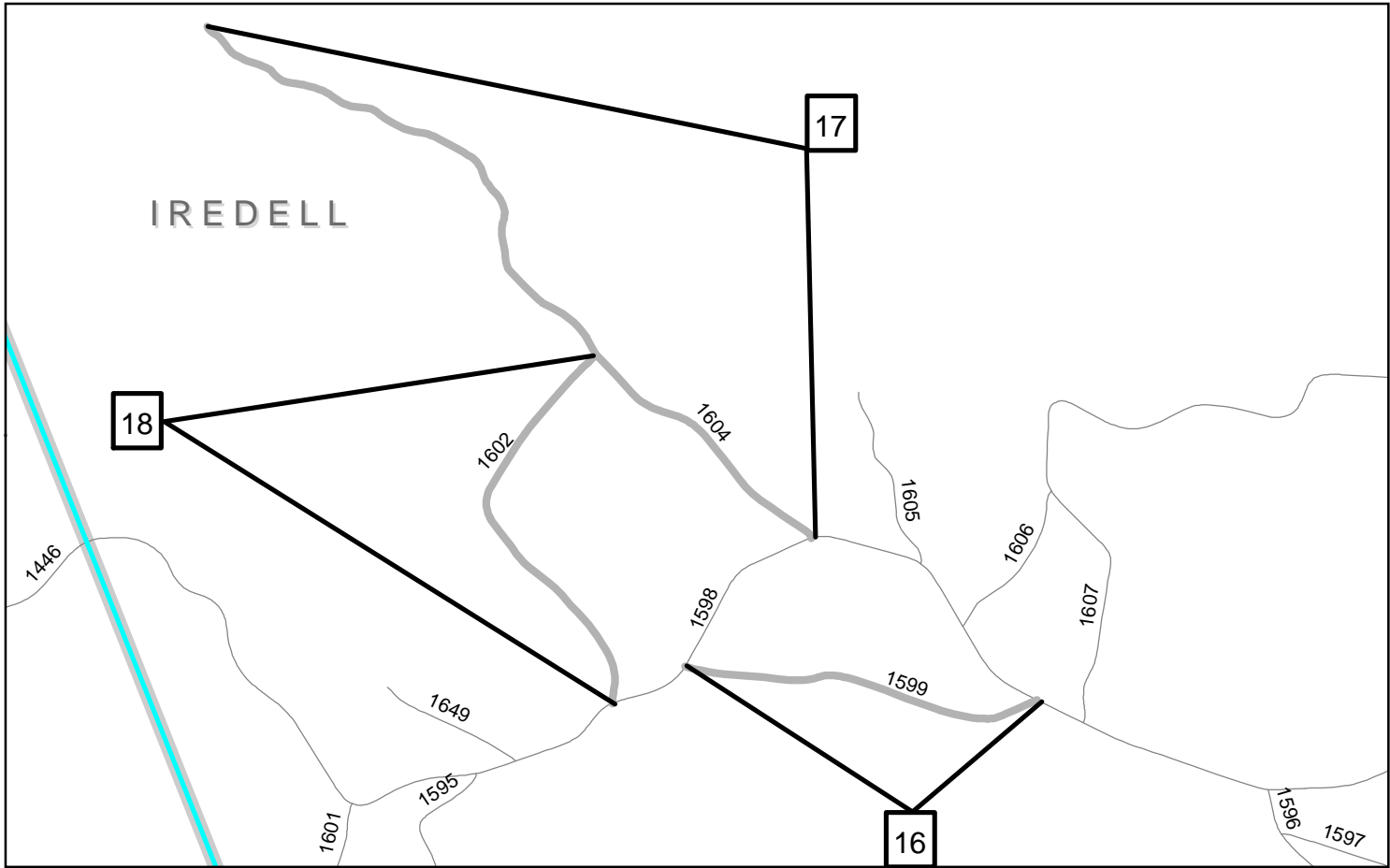

PAVEMENT SCHEDULE

STATE	PROJECT WBS	SHEET NUMBER
NC	2026CPT.12.09.20022	
	2026CPT.12.09.20492	

F	ASPHALT SURFACE TREATMENT, DOUBLE SEAL, USING A TOP LIFT OF LIGHTWEIGHT AGGREGATE AND A BOTTOM LIFT OF 78M AGGREGATE.
G	ASPHALT SURFACE TREATMENT, FOG SEAL, WITH A TARGET APPLICATION RATE OF 0.12 GAL/SY, +/- 0.03 GAL/SY.

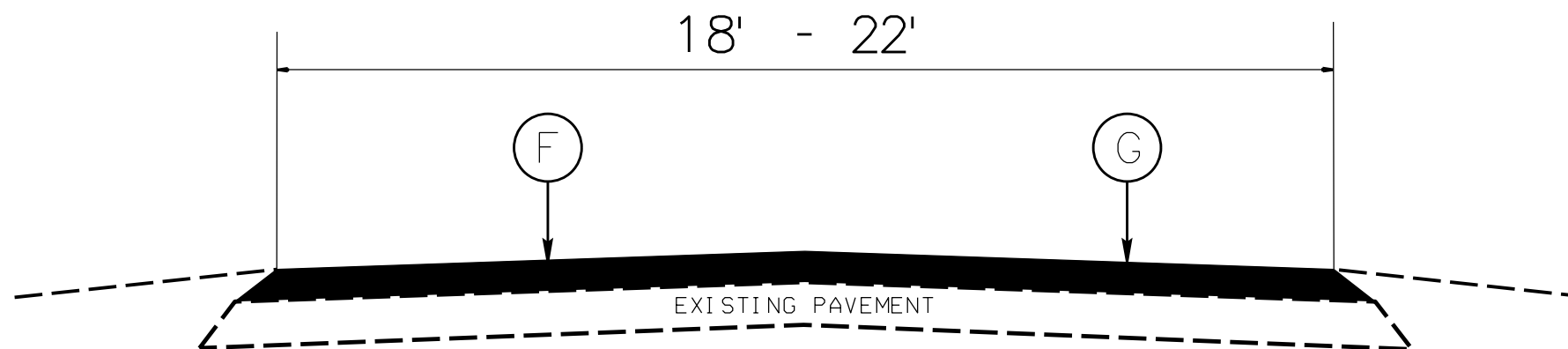

TYPICAL SECTION NO. 1

Typical Section
Alexander & Iredell Co.
2026-2027 Pvmt. Preservation

PROJECT NO.	SHEET NO.	TOTAL NO.
2026CPT.12.09.20022		
2026CPT.12.09.20492		

SUMMARY OF QUANTITIES

PROJECT NO	COUNTY	MAP NO	ROUTE	DESCRIPTION	TYP NO	LANES	LANE TYPE	LENGTH	WIDTH	BEGI	END	1803500000-E	1820000000-E	1838000000-E	2143000000-E
								MI	FT	N	MP	ASPHALT SURFACE TREATMENT, DOUBLE SEAL	ASPHALT SURFACE TREATMENT, FOG SEAL	EMULSION FOR ASPHALT SURFACE TREATMENT	BLOTTING SAND
												SY	SY	GAL	TON
2026CPT.12.09.20022	Alexander	1	SR-1301 / BLAIR RD	FROM SR 1348 (OLD NC 90) TO SR 1302 (DOVER CHURCH RD.)	1	2		1.335	20	0.000	1.335	17,230	17,230	8,960	10
2026CPT.12.09.20022	Alexander	2	SR-1315 / CHAPMAN MILL RD	FROM SR 1307 (ALL HEALING SPRINGS RD.) TO GRAYDON DYSON RD. (PRIVATE)	1	2		1.050	19	0.000	1.050	12,874	12,874	6,695	10
2026CPT.12.09.20022	Alexander	3	SR-1311 / GILL CHILDERS RD	FROM MAMA DESSIE LN. (PRIVATE) TO SR 1333 (BEBBER RD.)	1	2		0.580	20	0.500	1.080	7,486	7,486	3,893	5
2026CPT.12.09.20022	Alexander	4	SR-1441 / JUD SMITH RD	FROM SR 1403 (VASHTI RD.) TO SR 1001 (SULPHUR SPRINGS RD.)	1	2		2.094	20	0.000	2.094	26,975	26,975	14,027	20
2026CPT.12.09.20022	Alexander	5	SR-1442 / MARLOWE RD	FROM SR 1001 (SULPHUR SPRINGS RD.) TO SR 1441 (JUD SMITH RD.)	1	2		1.020	20	0.000	1.020	13,294	13,294	6,913	10
2026CPT.12.09.20022	Alexander	6	SR-1515 / HOPEWELL CHURCH RD	FROM SR 1001 (SULPHUR SPRINGS RD.) TO SR 1456 (CHEATHAM FORD RD.)	1	2		2.260	20	0.000	2.260	29,169	29,169	15,168	20
2026CPT.12.09.20022	Alexander	7	SR-1614 / HENRY RD	FROM SR 1605 (PAUL PAYNE STORE RD.) TO SR 1610 (MILLERSVILLE RD.)	1	2		1.466	20	0.000	1.466	18,921	18,921	9,839	15
2026CPT.12.09.20022	Alexander	8	SR-1618 / WELLMAN RD	FROM SR 1630 (MT. WESLEY CHURCH RD.) TO SR 1617 (LIBERTY CHURCH RD.)	1	2		1.499	20	0.000	1.499	19,347	19,347	10,060	15
TOTAL FOR PROJ NO. 2026CPT.12.09.20022								11.304				145,296	145,296	75,555	105
2026CPT.12.09.20492	Iredell	9	SR-1501 / WALNUT TREE RD	FROM SR 1500 (LOOKOUT DAM RD.) TO SR 1502 (SHARON SCHOOL RD.)	1	2		1.308	20	0.000	1.308	16,908	16,908	8,792	20
2026CPT.12.09.20492	Iredell	10	SR-1500 / LOOKOUT DAM RD	FROM SR 1501 (WALNUT TREE RD.) TO SR 1502 (SHARON SCHOOL RD.)	1	2		1.292	18	1.011	2.303	14,636	14,636	7,611	5
2026CPT.12.09.20492	Iredell	11	SR-1918 / LUNDY RD	FROM SR 1919 (FAIRMONT RD.) TO DEAD END	1	2		0.905	18	0.000	0.905	10,571	10,571	5,497	15
2026CPT.12.09.20492	Iredell	12	SR-1917 / MITCHELL FARM RD	FROM SR 1919 (FAIRMONT RD.) TO DEAD END	1	2		0.706	19	0.000	0.706	8,583	8,583	4,463	15
2026CPT.12.09.20492	Iredell	13	SR-2154 / NOEL RD	FROM US 21 TO CUL-DE-SAC	1	2		0.669	20	0.000	0.669	8,647	8,647	4,497	10
2026CPT.12.09.20492	Iredell	14	SR-1854 / HUIE RD	FROM SR 1852 (SLOANS MILL RD.) TO SR 1892 (JENNINGS RD.)	1	2		1.706	20	0.000	1.706	22,070	22,070	11,477	10
2026CPT.12.09.20492	Iredell	15	SR-1885 / MOSSWOOD RD	FROM SR 1892 (JENNINGS RD.) TO PAVEMENT END	1	2		0.460	20	0.815	1.275	5,937	5,937	3,087	10
2026CPT.12.09.20492	Iredell	16	SR-1599 / BURKE FARM LOOP	FROM SR 1598 (LINNEYS MILL RD.) TO SR 1598 (LINNEYS MILL RD.)	1	2		0.784	20	0.000	0.784	10,067	10,067	5,235	15
2026CPT.12.09.20492	Iredell	17	SR-1604 / OAK HOLLOW RD	FROM BEGINNING MAINTENANCE TO SR 1598 (LINNEYS MILL RD.)	1	2		1.815	20	0.000	1.815	23,490	23,490	12,215	5
2026CPT.12.09.20492	Iredell	18	SR-1602 / HILLSDALE RD	FROM SR 1598 (LINNEYS MILL RD.) TO SR 1604 (OAK HOLLOW RD.)	1	2		0.935	20	0.000	0.935	12,132	12,132	6,309	15
2026CPT.12.09.20492	Iredell	19	SR-1871 / TUCKERS GROVE RD	FROM SR 1870 (ARRINGTON RD.) TO NC 115	1	2		1.983	20	0.361	2.344	25,555	25,555	13,289	20
2026CPT.12.09.20492	Iredell	20	SR-1869 / BRUCE FARM RD	FROM NC 115 TO SR 1896 (FRIENDSHIP RD.)	1	2		1.801	20	0.000	1.801	23,232	23,232	12,081	20
2026CPT.12.09.20492	Iredell	21	SR-1870 / ARRINGTON RD	FROM SR 1869 (BRUCE FARM RD.) TO SR 1871 (TUCKERS GROVE RD.)	1	2		0.279	22	0.000	0.279	3,975	3,975	2,067	20
2026CPT.12.09.20492	Iredell	22	SR-1908 / BRANCHWOOD RD	FROM BEGINNING OF PAVEMENT TO NC 115	1	2		1.480	20	1.271	2.751	19,102	19,102	9,933	40
2026CPT.12.09.20492	Iredell	23	SR-1908 / BRANCHWOOD RD	FROM SR 1907 (SOUTH CHIPLEY FORD RD.) TO END OF PAVEMENT	1	2		0.380	20	0.000	0.380	4,905	4,905	2,550	20
2026CPT.12.09.20492	Iredell	24	SR-1857 / INDIAN HILL RD	FROM NC 901 TO SR 1852 (SLOANS MILL RD.)	1	2		3.033	20	0.000	3.033	39,146	39,146	20,356	50
TOTAL FOR PROJ NO. 2026CPT.12.09.20492								19.536				248,956	248,956	129,459	290
GRAND TOTAL								30.840				394,252	394,252	205,014	395

PROJECT NO.	SHEET NO.	TOTAL NO.
2026CPT.12.09.20022		
2026CPT.12.09.20492		

THERMOPLASTIC AND PAINT QUANTITIES

PROJECT NO	COUNTY	MAP NO	ROUTE	DESCRIPTION	TYP NO	LANES	LENGTH		BEGIN MP	END MP	4413000000-E	4457000000-N	4810000000-E	4810000000-E
							WORK ZONE ADVANCE/GENERAL WARNING SIGNING	TEMPORARY TRAFFIC CONTROL			4" WHITE PAINT	4" YELLOW PAINT		
							SF	LS			LF	LF		
2026CPT.12.09.20022	Alexander	1	SR-1301 / BLAIR RD	FROM SR 1348 (OLD NC 90) TO SR 1302 (DOVER CHURCH RD.)	1	2	1.335	20	0	1.335	160	*	31,015	31,015
2026CPT.12.09.20022	Alexander	2	SR-1315 / CHAPMAN MILL RD	FROM SR 1307 (ALL HEALING SPRINGS RD.) TO GRAYDON DYSON RD. (PRIVATE)	1	2	1.05	19	0	1.05	125	*	24,394	24,394
2026CPT.12.09.20022	Alexander	3	SR-1311 / GILL CHILDERS RD	FROM MAMA DESSIE LN. (PRIVATE) TO SR 1333 (BEBBER RD.)	1	2	0.58	20	0.5	1.08	75	*	13,475	13,475
2026CPT.12.09.20022	Alexander	4	SR-1441 / JUD SMITH RD	FROM SR 1403 (VASHTI RD.) TO SR 1001 (SULPHUR SPRINGS RD.)	1	2	2.094	20	0	2.094	250	*	48,555	48,555
2026CPT.12.09.20022	Alexander	5	SR-1442 / MARLOWE RD	FROM SR 1001 (SULPHUR SPRINGS RD.) TO SR 1441 (JUD SMITH RD.)	1	2	1.02	20	0	1.02	125	*	23,929	23,929
2026CPT.12.09.20022	Alexander	6	SR-1515 / HOPEWELL CHURCH RD	FROM SR 1001 (SULPHUR SPRINGS RD.) TO SR 1456 (CHEATHAM FORD RD.)	1	2	2.26	20	0	2.26	275	*	52,504	52,504
2026CPT.12.09.20022	Alexander	7	SR-1614 / HENRY RD	FROM SR 1605 (PAUL PAYNE STORE RD.) TO SR 1610 (MILLERSVILLE RD.)	1	2	1.466	20	0	1.466	175	*	34,058	34,058
2026CPT.12.09.20022	Alexander	8	SR-1618 / WELLMAN RD	FROM SR 1630 (MT. WESLEY CHURCH RD.) TO SR 1617 (LIBERTY CHURCH RD.)	1	2	1.499	20	0	1.499	175	*	34,825	34,825
TOTAL FOR PROJ NO. 2026CPT.12.09.20022							11.304				1,360	*	262,755	262,755
2026CPT.12.09.20492	Iredell	9	SR-1501 / WALNUT TREE RD	FROM SR 1500 (LOOKOUT DAM RD.) TO SR 1502 (SHARON SCHOOL RD.)	1	2	1.308	20	0	1.308	150	*	30,434	30,434
2026CPT.12.09.20492	Iredell	10	SR-1500 / LOOKOUT DAM RD	FROM SR 1501 (WALNUT TREE RD.) TO SR 1502 (SHARON SCHOOL RD.)	1	2	1.292	18	1.011	2.303	150	*	29,272	29,272
2026CPT.12.09.20492	Iredell	11	SR-1918 / LUNDY RD	FROM SR 1919 (FAIRMONT RD.) TO DEAD END	1	2	0.905	18	0	0.905	105	*	21,141	21,141
2026CPT.12.09.20492	Iredell	12	SR-1917 / MITCHELL FARM RD	FROM SR 1919 (FAIRMONT RD.) TO DEAD END	1	2	0.706	19	0	0.706	80	*	16,262	16,262
2026CPT.12.09.20492	Iredell	13	SR-2154 / NOEL RD	FROM US 21 TO CUL-DE-SAC	1	2	0.669	20	0	0.669	80	*	15,565	15,565
2026CPT.12.09.20492	Iredell	14	SR-1854 / HUIE RD	FROM SR 1852 (SLOANS MILL RD.) TO SR 1892 (JENNINGS RD.)	1	2	1.706	20	0	1.706	200	*	39,727	39,727
2026CPT.12.09.20492	Iredell	15	SR-1885 / MOSSWOOD RD	FROM SR 1892 (JENNINGS RD.) TO PAVEMENT END	1	2	0.46	20	0.815	1.275	55	*	10,687	10,687
2026CPT.12.09.20492	Iredell	16	SR-1599 / BURKE FARM LOOP	FROM SR 1598 (LINNEYS MILL RD.) TO SR 1598 (LINNEYS MILL RD.)	1	2	0.784	20	0	0.784	90	*	18,121	18,121
2026CPT.12.09.20492	Iredell	17	SR-1604 / OAK HOLLOW RD	FROM BEGINNING MAINTENANCE TO SR 1598 (LINNEYS MILL RD.)	1	2	1.815	20	0	1.815	205	*	42,282	42,282
2026CPT.12.09.20492	Iredell	18	SR-1602 / HILLSDALE RD	FROM SR 1598 (LINNEYS MILL RD.) TO SR 1604 (OAK HOLLOW RD.)	1	2	0.935	20	0	0.935	105	*	21,838	21,838
2026CPT.12.09.20492	Iredell	19	SR-1871 / TUCKERS GROVE RD	FROM SR 1870 (ARRINGTON RD.) TO NC 115	1	2	1.983	20	0.361	2.344	225	*	45,999	45,999
2026CPT.12.09.20492	Iredell	20	SR-1869 / BRUCE FARM RD	FROM NC 115 TO SR 1896 (FRIENDSHIP RD.)	1	2	1.801	20	0	1.801	205	*	41,818	41,818
2026CPT.12.09.20492	Iredell	21	SR-1870 / ARRINGTON RD	FROM SR 1869 (BRUCE FARM RD.) TO SR 1871 (TUCKERS GROVE RD.)	1	2	0.279	22	0	0.279	35	*	6,505	6,505
2026CPT.12.09.20492	Iredell	22	SR-1908 / BRANCHWOOD RD	FROM BEGINNING OF PAVEMENT TO NC 115	1	2	1.48	20	1.271	2.751	165	*	34,383	34,383
2026CPT.12.09.20492	Iredell	23	SR-1908 / BRANCHWOOD RD	FROM SR 1907 (SOUTH CHIPLEY FORD RD.) TO END OF PAVEMENT	1	2	0.38	20	0	0.38	45	*	8,828	8,828
2026CPT.12.09.20492	Iredell	24	SR-1857 / INDIAN HILL RD	FROM NC 901 TO SR 1852 (SLOANS MILL RD.)	1	2	3.033	20	0	3.033	340	*	70,463	70,463
TOTAL FOR PROJ NO. 2026CPT.12.09.20492							19.536				2,235	*	453,325	453,325
GRAND TOTAL							30.84				3,595	1	716,080	716,080

SIGNING FOR ASPHALT SURFACE TREATMENT

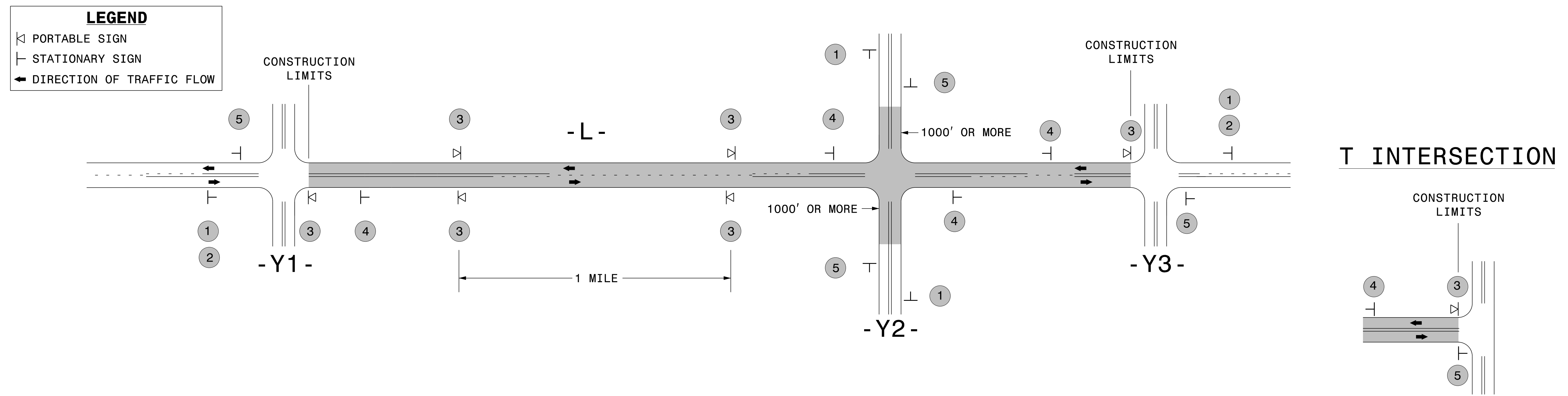

MAINLINE (-L-) SIGNING

-Y- LINE SIGNING

SIGNING NOTES AND PLACEMENT PER DIRECTION	1	 <small>W20-1 48" X 48"</small>	<ul style="list-style-type: none"> - PLACE 1000' PRIOR TO BEGINNING OF CONSTRUCTION LIMITS. - SIGN 2 MAY BE OMITTED FOR T INTERSECTIONS. FOLLOW T INTERSECTION SIGNING DETAIL ABOVE. - SIGN 2 MAY BE OMITTED WHEN CONSTRUCTION LIMITS ARE LESS THAN 2 MILES IN LENGTH. ROUND UP TO THE NEAREST WHOLE NUMBER. DO NOT USE FRACTIONAL OR DECIMAL NUMBERS. 	<p>NO STATIONARY SIGNING REQUIRED FOR THE FOLLOWING -Y- LINE CONDITIONS:</p> <ol style="list-style-type: none"> 1) LESS THAN 1000' OF RESURFACING ALONG -Y- LINE 2) SUBDIVISION ROADS 3) DEAD END ROADS <p>SIGNS 1 & 5 ARE REQUIRED FOR -Y- LINES WITH 1000' OR MORE OF RESURFACING OR PAVING</p> <p>WHEN PAVING/CONSTRUCTION ACTIVITIES PROCEED ACROSS AN UNSIGNED -Y- LINE, PORTABLE MOUNTED ADVANCE WARNING SIGNS SHALL BE USED ALONG THE -Y- LINE AS SHOWN BELOW. REMOVE UPON COMPLETION OF WORK.</p> <div style="display: flex; justify-content: space-around; align-items: center;"> <div style="text-align: center;"> <small>W20-1 48" X 48"</small> PLACED 500' IN ADVANCE OF FLAGGER </div> <div style="text-align: center;"> <small>W20-7 A 48" X 48"</small> PLACED 250' IN ADVANCE OF FLAGGER </div> </div>
	2	 <small>W7-3aP 24" X 18"</small>		
	3	<p style="text-align: center;">ALTERNATE SIGNS</p> <div style="display: flex; justify-content: space-around;"> <div style="text-align: center;"> <small>W8-7 48" X 48"</small> </div> <div style="text-align: center;"> <small>SP 48" X 48"</small> </div> </div> <div style="display: flex; justify-content: space-around; margin-top: 5px;"> <div style="text-align: center;"> <small>W8-15aP 24" X 18"</small> </div> <div style="text-align: center;"> <small>W8-15aP 24" X 18"</small> </div> </div>	<ul style="list-style-type: none"> - BEGIN SEQUENCE WITH LOOSE GRAVEL SIGN INSTALLED AT THE CONSTRUCTION LIMITS FOLLOWED BY AN UNMARKED PAVEMENT SIGN INSTALLED A MILE THEREAFTER. REPEAT SEQUENCE THROUGHOUT CONSTRUCTION LIMITS. - PLACE ADDITIONAL PORTABLE MOUNTED LOOSE GRAVEL SIGNS WITHIN 100' OF -Y- LINE APPROACH DURING CURE TIME. REMOVE WHEN PAVEMENT MARKINGS ARE INSTALLED. 	
	4	 <small>SP 13106 48" X 48"</small>	<ul style="list-style-type: none"> - INSTALL 500' FROM EACH -Y- LINE APPROACH AS SHOWN ABOVE. - FOR MULTIPLE -Y- LINES THAT ARE SEPARATED BY 0.25 MILES OR LESS, TREAT AS A SINGLE UNIT AND INSTALL WITHIN 500' OF EACH APPROACH. - FOR T INTERSECTIONS, INSTALL WITHIN 500' OF THE INTERSECTION. 	
	5	 <small>G20-2 A 36" X 18"</small>	<ul style="list-style-type: none"> - PLACE 500' FOLLOWING THE END OF CONSTRUCTION LIMITS OR WITHIN 100' OF T INTERSECTION AS SHOWN IN THE ABOVE DETAIL. 	

THE ABOVE SIGNS ARE ALL THAT ARE REQUIRED FOR A CONTRACTOR TO BEGIN A RESURFACING CONTRACT. ANY ADDITIONAL SIGNS REQUESTED BY NCDOT DIVISIONS SHALL BE INSTALLED WITHIN 7 BUSINESS DAYS OF THE START OF CONTRACT WORK.

MAPS LESS THAN 2 MILES

FOR AST RESURFACING MAPS WITH CONSTRUCTION LIMITS LESS THAN 2 MILES IN LENGTH, INSTALL A PORTABLE MOUNTED LOOSE GRAVEL (W8-7) SIGN AT THE BEGINNING CONSTRUCTION LIMIT, AN UNMARKED PAVEMENT (SP) SIGN MIDWAY THROUGH AND AN END ROAD WORK (G20-2A) SIGN AT THE END CONSTRUCTION LIMIT.

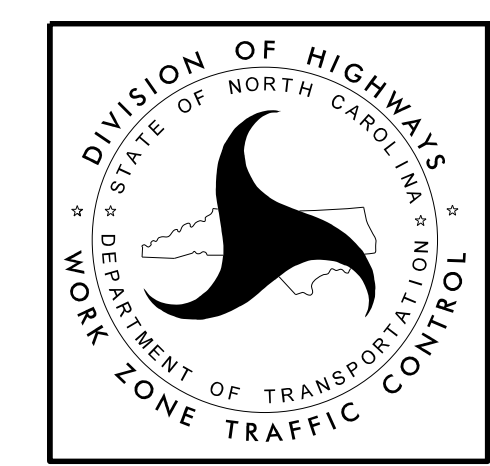

**ADVANCE WARNING SIGNS
FOR
2-LANE ROADWAY
ASPHALT SURFACE TREATMENT**

4/21/2026